

220 East Falls Street
Ithaca, NY 14850
Main Level

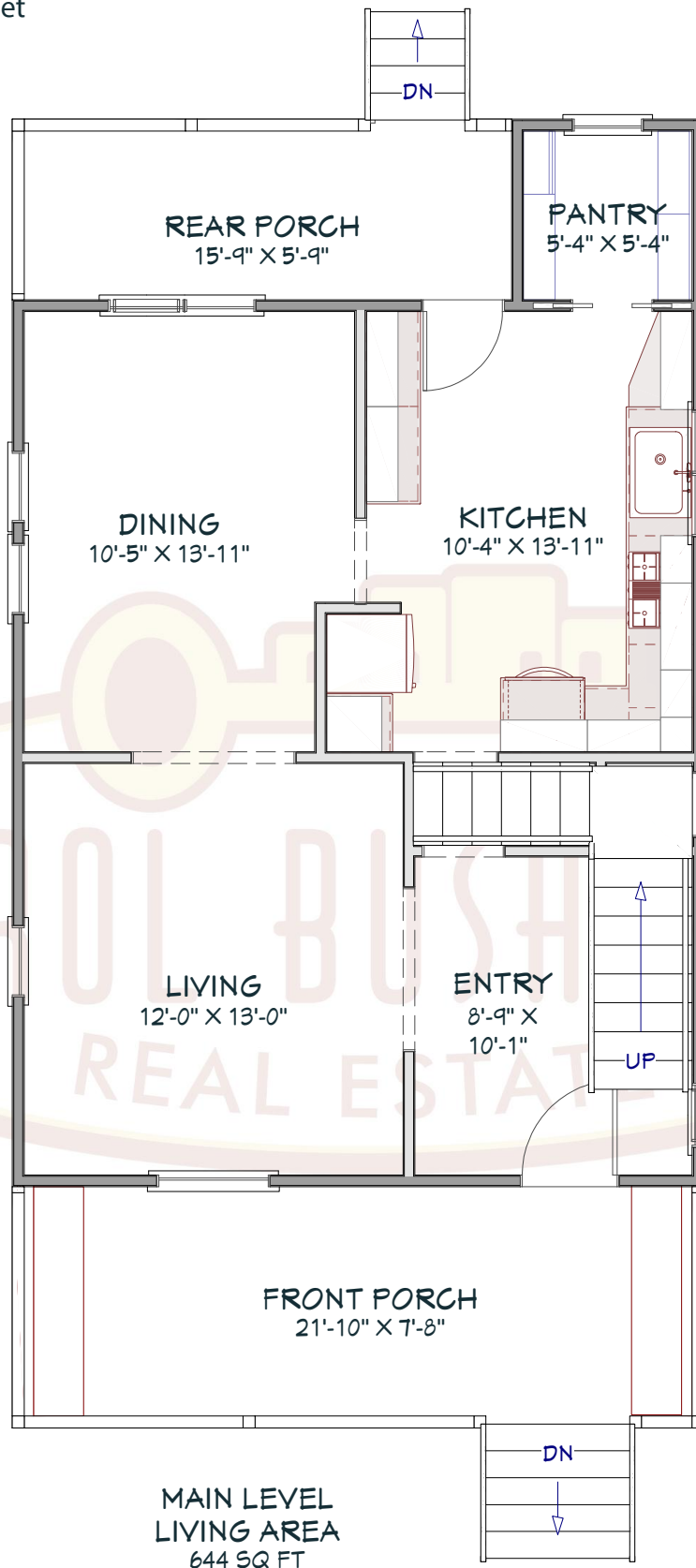

Please note: This plan was drawn by a Realtor, not an architect. As a result, the measurements are approximate and some elements of the property may be missing altogether. We do our best.

220 East Falls Street
Ithaca, NY 14850
Main Level



Please note: This plan was drawn by a Realtor, not an architect. As a result, the measurements are approximate and some elements of the property may be missing altogether. We do our best.

220 East Falls Street
Ithaca, NY 14850
Upper Level

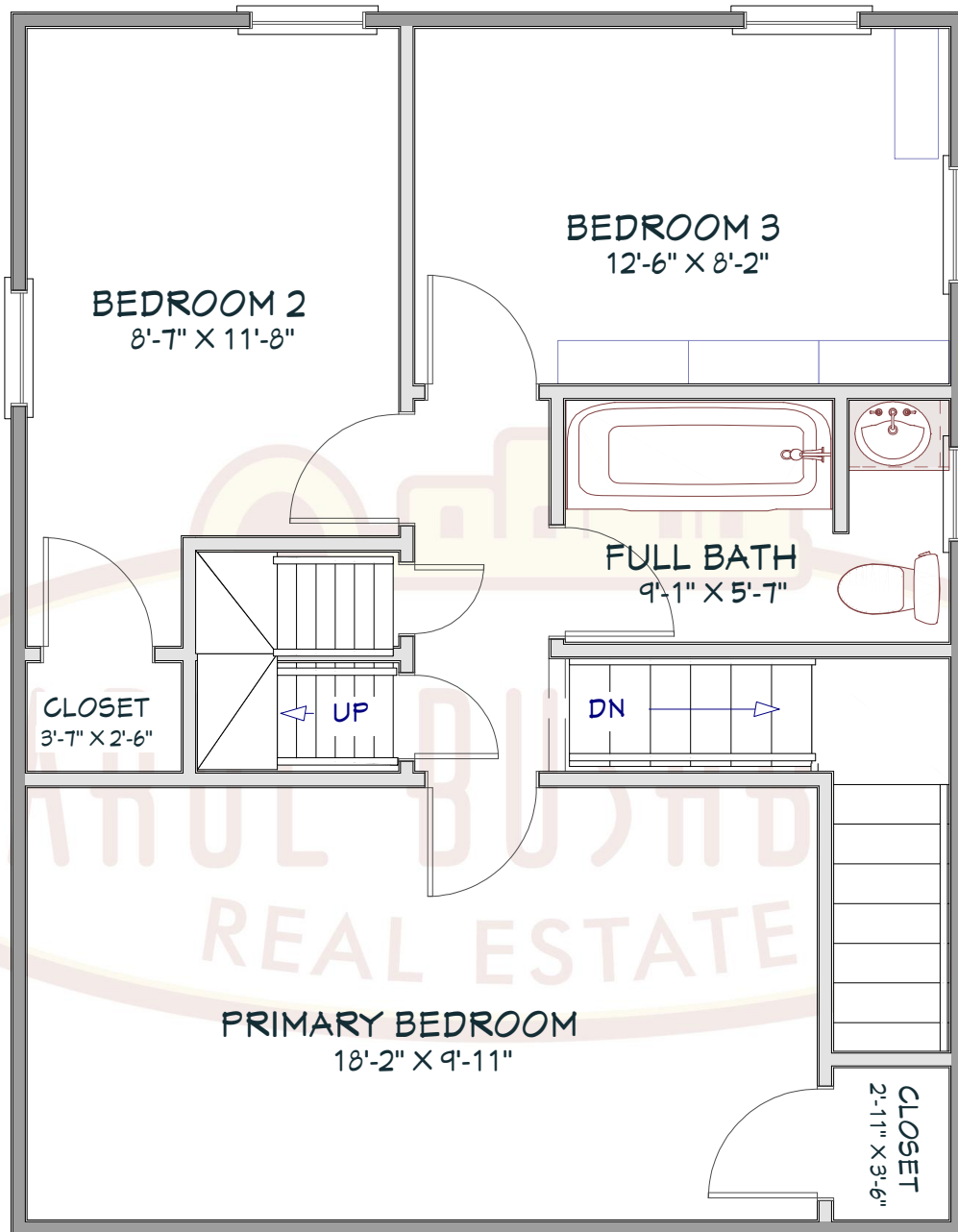

UPPER LEVEL
LIVING AREA
570 SQ FT

Please note: This plan was drawn by a Realtor, not an architect. As a result, the measurements are approximate and some elements of the property may be missing altogether. We do our best.

220 East Falls Street
Ithaca, NY 14850
Upper Level



Please note: This plan was drawn by a Realtor, not an architect. As a result, the measurements are approximate and some elements of the property may be missing altogether. We do our best.

220 East Falls Street
Ithaca, NY 14850
Attic

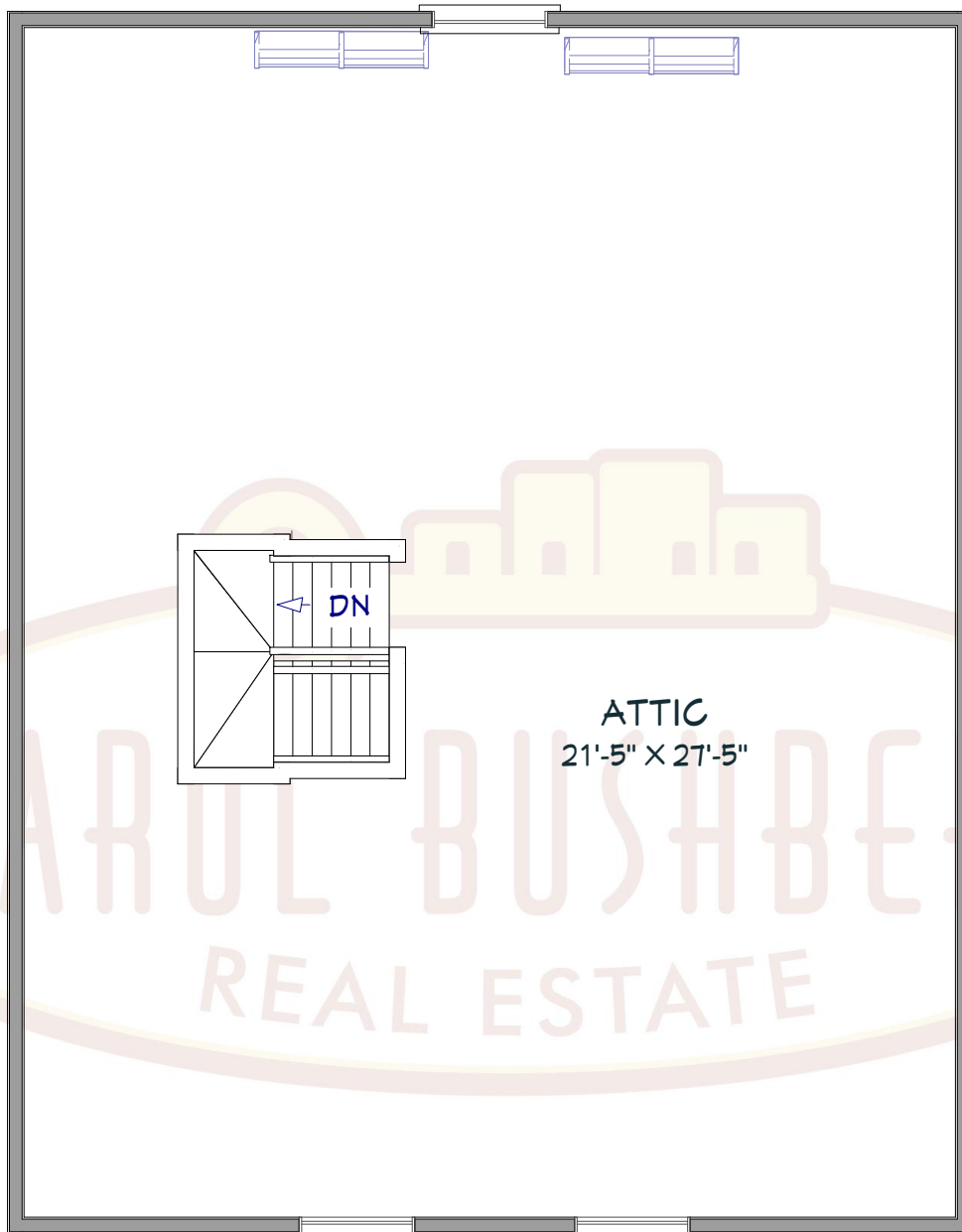

ATTIC AREA
599 SQ FT

Please note: This plan was drawn by a Realtor, not an architect. As a result, the measurements are approximate and some elements of the property may be missing altogether. We do our best.

220 East Falls Street
Ithaca, NY 14850
Attic
REAL ESTATE



Please note: This plan was drawn by a Realtor, not an architect. As a result, the measurements are approximate and some elements of the property may be missing altogether. We do our best.